

YE4

三相异步电动机

YE4 Series Three-phase Asynchronous Motor



YE4系列(中心高H80-355mm、0.55-375kw)电动机是全封闭、自扇风冷式鼠笼型三相异步电动机,产品能效与IEC60034-30的IE4保持一致。一般电压为380V、频率为50Hz,也可按客户要求定制。工作环境-15-40°C,海拔不超过1000M,绝缘等级F(B极考核)、防护等级IP55、冷却方式IC411、工作制S1、安装方式符合IEC和DIN标准。

YE4系列电动机为一般用途的电动机,适用于驱动无特殊要求的各种机械设备。YE4系列电动机满足GB18613-2020能效限值2级。

YE4 Series (Center height H80-355mm, power range 0.55-375kw) electric motor is full-enclosed fan cool squirrel cage three phase induction motor, Energy efficiency meet IE4, novelty appearance and firm structure. Usually 380V 50Hz and can also meet customer special requirement. Working environment: -15-40°C, altitude: below 1000m, insulation grade: class F, IP55, cooling method: IC411, Duty: S1, meet standards IEC and DIN, applied internationally in all kinds of machines that need motor drive. YE4 Series electric motor fit GB18613-2020 Eff2 is your best choice.

产品型号示例 Sample Product Model

YE4 — 180M — 2

极数:2极
Pole count: 2 poles

规格代号。表示中心高180mm,M机座
Specification code: 180mm high,M stand

产品代号,表示异步电动机。E4为符合IE4效率的设计。
Product code: represents asynchronous motor. E4 is designed to meet IE4 efficiency.

YE4 系列三相异步电动机安装及外形尺寸图 YE4 Series Motor Mounting and Overall Dimensions

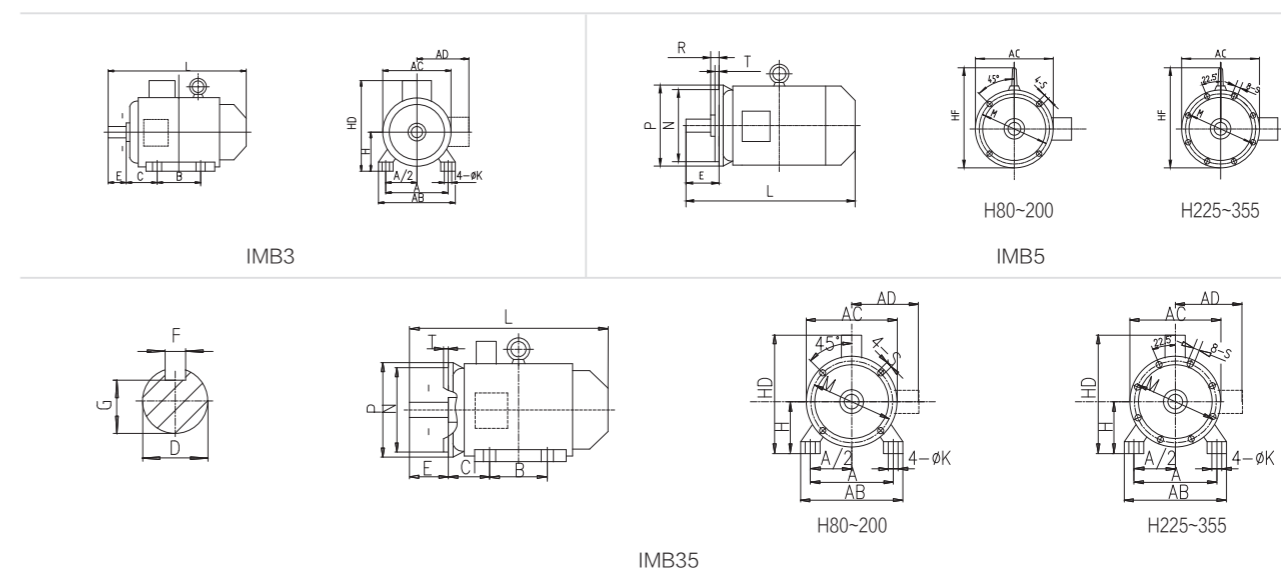

| 机座号 Frame Size | 级数 Pole | 安装尺寸Mounting Dimensions(mm) | | | | | | | | | | | | | | 外形尺寸Overall Dimensions(mm) | | | | | | |
|-------------------|------------|-----------------------------|-----|-----|----|-----|----|------|-----|------|-----|-----|-----|---|------|----------------------------|-----|-----|-----|------|-----|------|
| | | A | B | C | D | E | F | G | H | K | M | N | P | R | S | T | AB | AC | AD | HD | HF | L |
| 80M | | 125 | 100 | 50 | 19 | 40 | 6 | 15.5 | 80 | 10 | 165 | 130 | 200 | 0 | 12 | 3.5 | 165 | 175 | 145 | 220 | - | 310 |
| 90S | | 140 | 100 | 56 | 24 | 50 | 8 | 20 | 90 | 10 | 165 | 130 | 200 | 0 | 12 | 3.5 | 180 | 205 | 170 | 265 | - | 360 |
| 90L | | 140 | 125 | 56 | 24 | 50 | 8 | 20 | 90 | 10 | 165 | 130 | 200 | 0 | 12 | 3.5 | 180 | 205 | 170 | 265 | - | 390 |
| 100L | | 160 | 140 | 63 | 28 | 60 | 8 | 24 | 100 | 12 | 215 | 180 | 250 | 0 | 14.5 | 4 | 205 | 215 | 180 | 270 | 305 | 440 |
| 112M | | 190 | 140 | 70 | 28 | 60 | 8 | 24 | 112 | 12 | 215 | 180 | 250 | 0 | 14.5 | 4 | 230 | 255 | 200 | 310 | 275 | 470 |
| 132S | 2 | 216 | 140 | 89 | 38 | 80 | 10 | 33 | 132 | 12 | 265 | 230 | 300 | 0 | 14.5 | 4 | 270 | 310 | 230 | 365 | 335 | 515 |
| 132M | 4 | 216 | 178 | 89 | 38 | 80 | 10 | 33 | 132 | 12 | 265 | 230 | 300 | 0 | 14.5 | 4 | 270 | 310 | 230 | 365 | 335 | 550 |
| 160M | 6 | 254 | 210 | 108 | 42 | 110 | 12 | 37 | 160 | 14.5 | 300 | 250 | 350 | 0 | 18.5 | 5 | 320 | 340 | 260 | 425 | 390 | 730 |
| 160L | | 254 | 254 | 108 | 42 | 110 | 12 | 37 | 160 | 14.5 | 300 | 250 | 350 | 0 | 18.5 | 5 | 320 | 340 | 260 | 425 | 390 | 760 |
| 180M | | 279 | 241 | 121 | 48 | 110 | 14 | 42.5 | 180 | 14.5 | 300 | 250 | 350 | 0 | 18.5 | 5 | 355 | 390 | 285 | 460 | 435 | 770 |
| 180L | | 279 | 279 | 121 | 48 | 110 | 14 | 42.5 | 180 | 14.5 | 300 | 250 | 350 | 0 | 18.5 | 5 | 355 | 390 | 285 | 460 | 435 | 800 |
| 200L | | 318 | 305 | 133 | 55 | 110 | 16 | 49 | 200 | 18.5 | 350 | 300 | 400 | 0 | 18.5 | 5 | 395 | 445 | 320 | 520 | 495 | 860 |
| 225S | 4 | 356 | 286 | 149 | 60 | 140 | 18 | 53 | 225 | 18.5 | 400 | 350 | 450 | 0 | 18.5 | 5 | 435 | 495 | 350 | 575 | 550 | 830 |
| 225M | 2 | 356 | 311 | 149 | 55 | 110 | 16 | 49 | 225 | 18.5 | 400 | 350 | 450 | 0 | 18.5 | 5 | 435 | 495 | 350 | 575 | 550 | 830 |
| 225M | 4, 6 | | | | 60 | 140 | 18 | 53 | 225 | | | | | | | | 435 | 495 | 350 | 575 | 550 | 860 |
| 250M | 2 | 406 | 349 | 168 | 60 | 140 | 18 | 53 | 250 | | 500 | 450 | 550 | 0 | 18.5 | 5 | 490 | 550 | 390 | 635 | 615 | 990 |
| 250M | 4, 6 | | | | 65 | 140 | 18 | 58 | 250 | 24 | | | | | | | | | | | | |
| 280S | 2 | 457 | 368 | 190 | 65 | 140 | 18 | 58 | 280 | | 500 | 450 | 550 | 0 | 18.5 | 5 | 550 | 630 | 435 | 705 | 675 | 990 |
| 280S | 4, 6 | | | | 75 | 140 | 20 | 67.5 | 280 | 24 | | | | | | | | | | | | |
| 280M | 2 | 457 | 419 | 190 | 65 | 140 | 18 | 58 | 280 | | 500 | 450 | 550 | 0 | 18.5 | 5 | 550 | 630 | 435 | 705 | 675 | 1040 |
| 280M | 4, 6 | | | | 75 | 140 | 20 | 67.5 | 280 | 24 | | | | | | | | | | | | |
| 315S | 2 | 508 | 406 | 216 | 65 | 140 | 18 | 58 | 315 | | 600 | 550 | 660 | 0 | 24 | 6 | 635 | 645 | 530 | 845 | - | 1210 |
| 315S | 4, 6 | | | | 80 | 170 | 22 | 71 | 315 | 28 | | | | | | | | | | | | 1240 |
| 315M | 2 | 508 | 457 | 216 | 65 | 140 | 18 | 58 | 315 | | 600 | 550 | 660 | 0 | 24 | 6 | 635 | 645 | 530 | 845 | - | 1320 |
| 315M | 4, 6 | | | | 80 | 170 | 22 | 71 | 315 | 28 | | | | | | | | | | | | 1350 |
| 315L | 2 | 508 | 508 | 216 | 65 | 140 | 18 | 58 | 315 | | 600 | 550 | 660 | 0 | 24 | 6 | 635 | 645 | 530 | 845 | - | 1320 |
| 315L | 4, 6 | | | | 80 | 170 | 22 | 71 | 315 | 28 | | | | | | | | | | | | 1350 |
| 355M | 2 | 610 | 560 | 254 | 75 | 140 | 20 | 67.5 | 355 | | 740 | 680 | 800 | 0 | 24 | 6 | 730 | 710 | 665 | 1010 | - | 1510 |
| 355M | 4, 6 | | | | 95 | 170 | 25 | 86 | 355 | 28 | | | | | | | | | | | | 1550 |
| 355L | 2 | 610 | 630 | 254 | 75 | 140 | 20 | 67.5 | 355 | | 740 | 680 | 800 | 0 | 24 | 6 | 730 | 710 | 665 | 1010 | - | 1510 |
| 355L | 4, 6 | | | | 95 | 170 | 25 | 86 | 355 | 28 | | | | | | | | | | | | 1550 |

注:若有特殊要求,可按用户需求提供。 Please contact us with your requirement.

